

The JBC logo is rendered in a bold, italicized, red sans-serif font.

# JBC

[www.jbctools.com](http://www.jbctools.com)



## Heavy Duty station

High power for industrial soldering applications

## Why Heavy Duty?

**Highest Power**  
250 watts  
peak power

**The exclusive solution**  
for high thermal demands  
and prolonged soldering  
applications

## Heavy Duty station

Industrial use equipment ready to work intensively

Ref. **HDE-1B** 120 V, **HDE-2B** 230 V, **HDE-9B** 100 V

### Intuitive Menu

Easy browsing for working with total comfort



#### Customizable station

Personalize the parameters according to your work needs.



#### Partial counters

Total and partial time registration for each port: work, sleep and hibernation hours.



#### Graphics

Optimize soldering quality by analyzing the temperature and power data.



#### Communication Station-PC

Update station software and export graphics via PC.



#### B-Net, your Soldering Network

Organize, manage and control all the stations from your PC.



#### Robots

Automate the soldering process by managing the station via Robot.

#### **HDRE-B Robot station**

For repetitive jobs requiring precise movements. The Converter (Ref. CHB-A) is required.

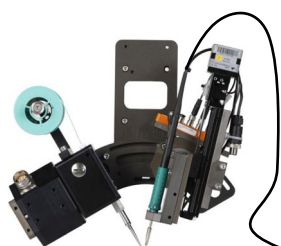

**Converter**  
Ref. CHB-A



# The answer to your needs

Used in production of solar panels,  
multi-layered circuits and components  
of large dissipation surfaces



**Increase productivity**  
Save time by using the **quick cartridge changer**.  
This allows you to work on different soldering jobs.

## Stand Extend the tip life

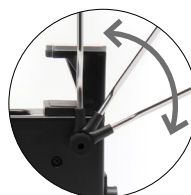

## Intelligent Heat Management

When the tool is placed on the stand the **Sleep & Hibernation** features reduce the temperature and extend a tip's life up to 5x longer.

## Suit position

The tool **holder** and the **cable collector** are easily **adjustable**.

## ESD Tip Cleaner Improve thermal transfer of the tip

Choose from 3 safe methods according to your needs: **brass wool**, **inox wool** or **sponge**.  
The integrated wiper also allows you to remove excess solder from the tip single-handedly.



Tip Wiper



Sponge

## Specifications

Dimensions	145 x 120 x 225 mm
HDE-A Weight	6,120 Kg (13.49 lb)
KHT470A Weight	1.665 kg (3.67 lb)
Output peak power	250 W
Ref. - Voltage (AC) / Fuse	<b>HDE-1B</b> - 120 V / 4A
	<b>HDE-2B</b> - 230 V / 2A
	<b>HDE-9B</b> - 100 V / 4A

Temperature selection	90 - 500 °C (190 - 932 °F)
Idle Temp. Stability	±1.5 °C (±3 °F)
Tip to ground voltage	< 2 mV RMS
Tip to groun resistance	<2 ohms
Ambient operating temp.	10 - 40 °C (50 - 104 °F)
Communication connectors	USB-A, USB-B, Peripherals
Robot connector	RJ12 for RS-232 connection



# Connectables

## HD Thermal Tweezers

Reduce handling time

### KHT470A HD Tweezers Kit

It requires 2 HDE Heavy Duty control units in order to manage the cartridges individually and optimize their thermal performance.



## T470 HD Handles

For greater demands

For intensive soldering jobs requiring continued high thermal power. They feature a non-slip-grip with a good thermal insulation and a screw which fixes the cartridge and prevents rotation.

### T470-A HD Purposes

### T470-B Heavy Duty HD

### T470-SA HD Purposes with 3m cable



### T470-FA Thermal Insulation Grip

### T470-MC Soft Thermal Insulation Grip with 3m cable

### T470-ZA Tri-lobed grip

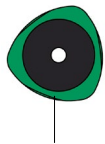

Tri-lobed shape for better handling

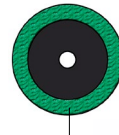

Foam



### T470-NA HD Nitrogen



The JBC GN-A Nitrogen Generator Module or an external nitrogen feed is needed.

## C470 Cartridge range

Find the C470 cartridges that best suit your needs in [www.jbctools.com](http://www.jbctools.com)

4x1,3



C470-014

15,5x2,5

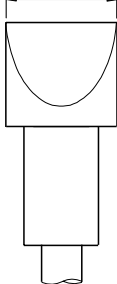

C470-007

ø 1,7



C470-001

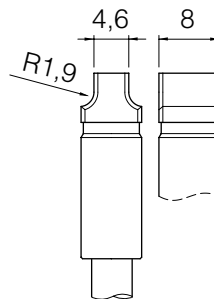

C470-050

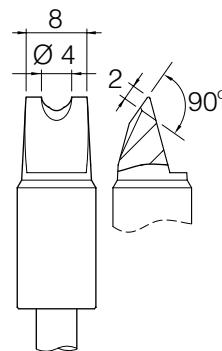

C470-055

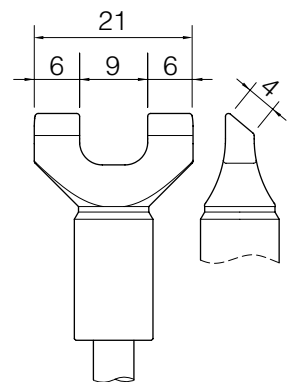

C470-051

E 1:1

